

# PRODUCT INFORMATION SHEET

## Polarization Maintaining Fiber Collimator (PMC Series)

The PM Fiber Collimator is the basic element for in-line PM fiber optics components, such as PM isolator and PM FWDM. It has high extinction ratio, low insertion and high return loss. The unique processing and high quality AR coating also enable this collimator to handle high power.

### Specifications

Parameters	Unit	Values
Center Wavelength	nm	1310,1550 or Specify
Operating Wavelength Range	nm	±30
Working Distance	mm	5 or Specify
Typ. Insertion Loss @ 5mm	dB	0.20
Max. Insertion Loss @ 5mm	dB	0.25
Typ. Extinction Ratio	dB	25
Min. Extinction Ratio	dB	22
Min. Return Loss	dB	60
Tensile Load	N	5
Fiber Type		PM Panda Fiber or Specify
Operating Temperature	°C	-5 to +70
Storage Temperature	°C	-40 to +85

\*Above specifications are for device without connector. PM fiber & connector key are aligned to the slow axis.

\*For devices with connectors, IL will be 0.3dB higher, RL will be 5dB lower, and ER will be 2dB lower.

### Package Dimensions

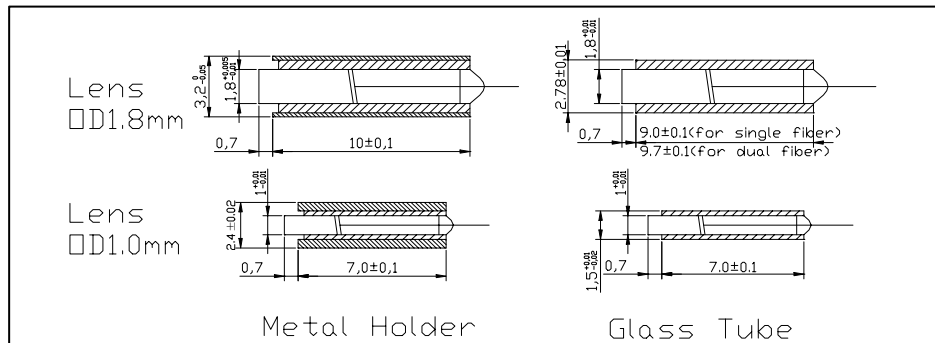

### Figure for Slow axis orientation

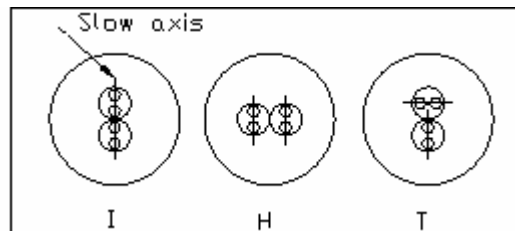

### Ordering Information

PMC-①-②-③-④-⑤-⑥-⑦-⑧-⑨

- |   |   |  |  |   |
|---|---|--|--|---|
| ① Lens Diameter<br>1 - 1.8mm<br>2 - 1.0mm(for single fiber only)<br>S - Specify | ② Pigtail Type<br>1 - Single fiber pigtail<br>2 - Dual fiber pigtail<br>S - Specify                               | ③ Center Wavelength<br>1 - 1310nm<br>2 - 1550nm<br>SS - Specify  | ④ Package Type<br>1 - Metal holder<br>2 - Glass tube | ⑤ Working Distance<br>1 - 5 mm<br>S - Specify |
| ⑥ Connector Type<br>N - None<br>S - Specify                                     | ⑦ Fiber Type<br>B - 250um Panda Fiber<br>D - 400um Panda Fiber<br>L - 900um loose tube Panda Fiber<br>S - Specify | ⑧ Slow Axis orientation<br>O - For single fiber collimator<br>I, H, T - For Dual fiber collimator(refer to figure) | ⑨ Fiber Length<br>C - 1.5m<br>S - Specify            |   |